

MODEL EP EXPANSION JOINT 150PSI FLANGE END

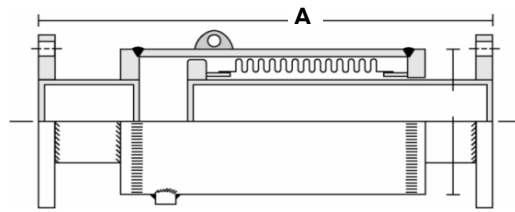

FLANGED ENDS



The externally pressurized EP solves the problem of long axial travel for expansion joints. It comes standard for movements of 4", 6" and 8". They are available in 150 and 300 psi models, and can be configured as doubles if required.

Maximum Working Pressure 150 psi
 Working Temperature 850°F
 Test Pressure 225 psi
 Bellows 2-Ply T304 S/S
 Ends 150# Flanges

Dim		Movements			Physicals		Weight	Product No.	Dim		Movements			Physicals		Weight	Product No.
Pipe Size	Type	Length A	Ax Comp	Ax Ext	Thrust Area	Stiffness			Pipe Size	Type	Length A	Ax Comp	Ax Ext	Thrust Area	Stiffness		
in	S/M/L	in	in	in	in ²	lbs/in	lbs	in	S/M/L	in	in	in	in ²	lbs/in	lbs		
2	S	25	4	0.75	13	183	34	EP1504SF0200	10	S	27	4	0.75	125	400	240	EP1504SF1000
2	M	31.5	6	1	13	115	41	EP1506SF0200	10	M	34	6	1	125	280	281	EP1506SF1000
2	L	38.5	8	1.5	13	92	50	EP1508SF0200	10	L	40.25	8	1.5	125	200	342	EP1508SF1000
2.5	S	25	4	0.75	13	183	40	EP1504SF0250	12	S	27	4	0.75	167	463	308	EP1504SF1200
2.5	M	32	6	1	13	115	48	EP1506SF0250	12	M	33.25	6	1	167	326	355	EP1506SF1200
2.5	L	38.5	8	1.5	13	92	58	EP1508SF0250	12	L	39.75	8	1.5	167	235	428	EP1508SF1200
3	S	24	4	0.75	21	343	51	EP1504SF0300	14	S	28.25	4	0.75	212	1328	491	EP1504SF1400
3	M	30	6	1	21	235	60	EP1506SF0300	14	M	36	6	1	212	885	565	EP1506SF1400
3	L	38.5	8	1.5	21	172	75	EP1508SF0300	14	L	45.5	8	1.5	212	1053	671	EP1508SF1400
4	S	25	4	0.75	36	200	61	EP1504SF0400	16	S	28.75	4	0.75	276	1425	547	EP1504SF1600
4	M	31.25	6	1	36	143	89	EP1506SF0400	16	M	36.25	6	1	276	950	631	EP1506SF1600
4	L	37.75	8	1.5	36	103	110	EP1508SF0400	16	L	46	8	1.5	276	712	749	EP1508SF1600
5	S	25	4	0.75	47	235	112	EP1504SF0500	18	S	29	4	0.75	338	1596	652	EP1504SF1800
5	M	31.5	6	1	47	166	133	EP1506SF0500	18	M	36.5	6	1	338	1064	745	EP1506SF1800
5	L	38.25	8	1.5	47	120	165	EP1508SF0500	18	L	46.25	8	1.5	338	798	875	EP1508SF1800
6	S	25.5	4	0.75	59	269	138	EP1504SF0600	20	S	29.75	4	0.75	404	1766	766	EP1504SF2000
6	M	32.25	6	1	59	189	162	EP1506SF0600	20	M	37.25	6	1	404	1177	868	EP1506SF2000
6	L	38.5	8	1.5	59	138	200	EP1508SF0600	20	L	47	8	1.5	404	883	1012	EP1508SF2000
8	S	28.25	4	0.75	89	332	198	EP1504SF0800	24	S	30.25	4	0.75	481	1936	961	EP1504SF2400
8	M	34.75	6	1	89	235	230	EP1506SF0800	24	M	38	6	1	481	1290	1081	EP1506SF2400
8	L	42	8	1.5	89	166	283	EP1508SF0800	24	L	47.5	8	1.5	481	968	1250	EP1508SF2400

	Proposal/Inquiry/Order No.:	NOTES:
	Customer Name:	
Project Name:		
Contractor:		
Model EP expansion joints combine excellent performance and economy. They can usually be provided quickly.		
PRINT CERTIFICATION:		
Certified Correct As Of: _____		
By: _____		

MODEL EP EXPANSION JOINT 150PSI WELD END

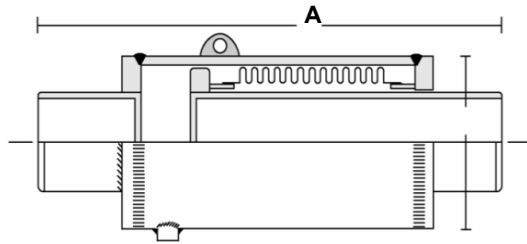

WELD ENDS



The externally pressurized EP solves the problem of long axial travel for expansion joints. It comes standard for movements of 4", 6" and 8". They are available in 150 and 300 psi models, and can be configured as doubles if required.

Maximum Working Pressure 150 psi
 Working Temperature 850°F
 Test Pressure 225 psi
 Bellows 2-Ply T304 S/S
 Ends Weld Ends

Dim		Movements			Physicals		Weight	Product No.	Dim		Movements			Physicals		Weight	Product No.
Pipe Size	Type	Length A	Ax Comp	Ax Ext	Thrust Area	Stiffness			Pipe Size	Type	Length A	Ax Comp	Ax Ext	Thrust Area	Stiffness		
in	S/M/L	in	in	in	in ²	lbs/in	lbs	in	S/M/L	in	in	in	in ²	lbs/in	lbs		
2	S	24.25	4	0.75	13	183	26	EP1504SW0200	10	S	26	4	0.75	125	400	186	EP1504SW1000
2	M	31	6	1	13	115	33	EP1506SW0200	10	M	33	6	1	125	280	227	EP1506SW1000
2	L	37.75	8	1.5	13	92	42	EP1508SW0200	10	L	39.25	8	1.5	125	200	238	EP1508SW1000
2.5	S	24.5	4	0.75	13	183	29	EP1504SW0250	12	S	26	4	0.75	167	463	226	EP1504SW1200
2.5	M	31.25	6	1	13	115	37	EP1506SW0250	12	M	32.25	6	1	167	326	273	EP1506SW1200
2.5	L	38	8	1.5	13	92	47	EP1508SW0250	12	L	38.75	8	1.5	167	235	346	EP1508SW1200
3	S	23.25	4	0.75	21	343	38	EP1504SW0300	14	S	24.5	4	0.75	212	1328	293	EP1504SW1400
3	M	29.5	6	1	21	235	47	EP1506SW0300	14	M	32	6	1	212	885	367	EP1506SW1400
3	L	37.75	8	1.5	21	172	62	EP1508SW0300	14	L	41.75	8	1.5	212	1053	473	EP1508SW1400
4	S	24.25	4	0.75	36	200	59	EP1504SW0400	16	S	24.5	4	0.75	276	1425	329	EP1504SW1600
4	M	30.75	6	1	36	143	73	EP1506SW0400	16	M	32	6	1	276	950	412	EP1506SW1600
4	L	37.25	8	1.5	36	103	94	EP1508SW0400	16	L	41.75	8	1.5	276	712	530	EP1508SW1600
5	S	24.25	4	0.75	47	235	91	EP1504SW0500	18	S	24.5	4	0.75	338	1596	364	EP1504SW1800
5	M	30.75	6	1	47	166	112	EP1506SW0500	18	M	32	6	1	338	1064	456	EP1506SW1800
5	L	37.5	8	1.5	47	120	144	EP1508SW0500	18	L	41.75	8	1.5	338	798	588	EP1508SW1800
6	S	24.75	4	0.75	59	269	115	EP1504SW0600	20	S	24.5	4	0.75	404	1766	400	EP1504SW2000
6	M	31.5	6	1	59	189	139	EP1506SW0600	20	M	32	6	1	404	1177	501	EP1506SW2000
6	L	37.75	8	1.5	59	138	177	EP1508SW0600	20	L	41.75	8	1.5	404	883	646	EP1508SW2000
8	S	27.25	4	0.75	89	332	153	EP1504SW0800	24	S	24.5	4	0.75	481	1936	472	EP1504SW2400
8	M	33.75	6	1	89	235	185	EP1506SW0800	24	M	32	6	1	481	1290	590	EP1506SW2400
8	L	41	8	1.5	89	166	238	EP1508SW0800	24	L	41.75	8	1.5	481	968	761	EP1508SW2400

	Proposal/Inquiry/Order No.:	NOTES:
	Customer Name:	
Project Name:		
Contractor:		
Model EP expansion joints combine excellent performance and economy. They can usually be provided quickly.		
PRINT CERTIFICATION: Certified Correct As Of: _____ By: _____		

MODEL EP EXPANSION JOINT 300PSI FLANGE END

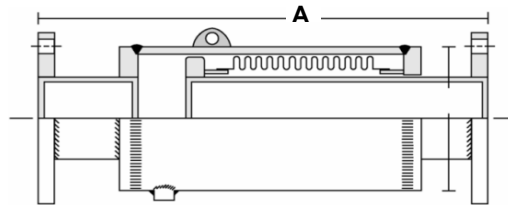

FLANGED

The externally pressurized EP solves the problem of long axial travel for expansion joints. It comes standard for movements of 4", 6" and 8". They are available in 150 and 300 psi models, and can be configured as doubles if required.

Maximum Working Pressure 300 psi
 Working Temperature 850°F
 Test Pressure 450 psi
 Bellows 2-Ply T304 S/S
 Ends 300# Flanges

Dim		Movements			Physicals		Weight	Product No.	Dim		Movements			Physicals		Weight	Product No.
Pipe Size	Type	Length A	Ax Comp	Ax Ext	Thrust Area	Stiffness			Pipe Size	Type	Length A	Ax Comp	Ax Ext	Thrust Area	Stiffness		
in	L/M/S	in	in	in	in ²	lbs/in	lbs	in	L/M/S	in	in	in	in ²	lbs/in	lbs		
2	S	25.75	4	0.75	12	388	49	EPD3004SF0200	10	S	28.5	4	0.75	135	3266	396	EPD3004SF1000
2	M	34.75	6	1	12	260	63	EPD3006SF0200	10	M	35.75	6	1	135	2177	452	EPD3006SF1000
2	L	41.75	8	1.5	12	194	72	EPD3008SF0200	10	L	44.75	8	1.5	135	1633	534	EPD3008SF1000
2.5	S	25.75	4	0.75	12	388	56	EPD3004SF0250	12	S	30.5	4	0.75	182	3491	540	EPD3004SF1200
2.5	M	34.75	6	1	12	260	73	EPD3006SF0250	12	M	38.25	6	1	182	2327	610	EPD3006SF1200
2.5	L	41.75	8	1.5	12	194	84	EPD3008SF0250	12	L	47.75	8	1.5	182	1745	712	EPD3008SF1200
3	S	24.5	4	0.75	16	504	75	EPD3004SF0300	14	S	30.75	4	0.75	212	2656	732	EPD3004SF1400
3	M	31	6	1	16	380	87	EPD3006SF0300	14	M	38.5	6	1	212	1770	828	EPD3006SF1400
3	L	39.5	8	1.5	16	252	106	EPD3008SF0300	14	L	48	8	1.5	212	1328	966	EPD3008SF1400
4	S	25.75	4	0.75	30	850	121	EPD3004SF0400	16	S	31.5	4	0.75	276	2850	798	EPD3004SF1600
4	M	32.5	6	1	30	566	141	EPD3006SF0400	16	M	39.25	6	1	276	1900	905	EPD3006SF1600
4	L	41.25	8	1.5	30	424	170	EPD3008SF0400	16	L	48.75	8	1.5	276	1424	1060	EPD3008SF1600
5	S	24.5	4	0.75	42	1002	158	EPD3004SF0500	18	S	31.75	4	0.75	338	3192	1007	EPD3004SF1800
5	M	30.75	6	1	42	668	181	EPD3006SF0500	18	M	39.5	6	1	338	2128	1126	EPD3006SF1800
5	L	36.75	8	1.5	42	501	203	EPD3008SF0500	18	L	49	8	1.5	338	1596	1297	EPD3008SF1800
6	S	25.25	4	0.75	53	1140	190	EPD3004SF0600	20	S	32	4	0.75	404	3532	1189	EPD3004SF2000
6	M	31.25	6	1	53	760	214	EPD3006SF0600	20	M	39.75	6	1	404	2354	1319	EPD3006SF2000
6	L	37.5	8	1.5	53	570	239	EPD3008SF0600	20	L	49.25	8	1.5	404	1766	1507	EPD3008SF2000
8	S	26.75	4	0.75	83	2424	295	EPD3004SF0800	24	S	33	4	0.75	481	3872	1619	EPD3004SF2400
8	M	33.5	6	1	83	1616	336	EPD3006SF0800	24	M	40.75	6	1	481	2580	1772	EPD3006SF2400
8	L	40	8	1.5	83	1212	377	EPD3008SF0800	24	L	50.25	8	1.5	481	1936	1993	EPD3008SF2400

	Proposal/Inquiry/Order No.:	NOTES:
	Customer Name:	
	Project Name:	
	Contractor:	
PRINT CERTIFICATION: Certified Correct As Of: _____ By: _____	Model EP expansion joints combine excellent performance and economy. They can usually be provided quickly.	

MODEL EP EXPANSION JOINT 300PSI WELD END

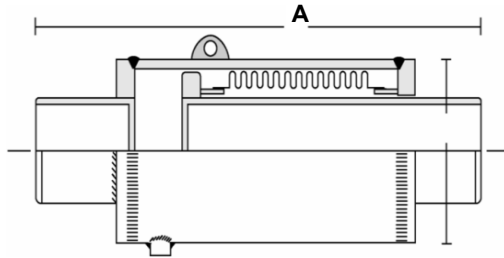

WELD

The externally pressurized EP solves the problem of long axial travel for expansion joints. It comes standard for movements of 4", 6" and 8". They are available in 150 and 300 psi models, and can be configured as doubles if

Maximum Working Pressure 300 psi
 Working Temperature 850°F
 Test Pressure 450 psi
 Bellows 2-Ply T304 S/S
 Ends Weld Ends

Dim			Movements		Physicals		Weight	Product No.	Dim			Movements		Physicals		Weight	Product No.
Pipe Size	Type	Length A	Ax Comp	Ax Ext	Thrust Area	Stiffness			Pipe Size	Type	Length A	Ax Comp	Ax Ext	Thrust Area	Stiffness		
in	S/M/L	in	in	in	in ²	lbs/in	lbs	in	L/M/S	in	in	in	in ²	lbs/in	lbs		
2	S	23.25	4	0.75	12	388	35	EPD3004SW0200	10	S	23.75	4	0.75	135	3266	216	EPD3004SW1000
2	M	32	6	1	12	260	48	EPD3006SW0200	10	M	30.75	6	1	135	2177	272	EPD3006SW1000
2	L	39.25	8	1.5	12	194	58	EPD3008SW0200	10	L	40	8	1.5	135	1633	354	EPD3008SW1000
2.5	S	23.25	4	0.75	12	388	36	EPD3004SW0250	12	S	25	4	0.75	182	3491	285	EPD3004SW1200
2.5	M	32	6	1	12	260	52	EPD3006SW0250	12	M	32.5	6	1	182	2327	355	EPD3006SW1200
2.5	L	39.25	8	1.5	12	194	63	EPD3008SW0250	12	L	42.25	8	1.5	182	1745	457	EPD3008SW1200
3	S	22.25	4	0.75	16	504	47	EPD3004SW0300	14	S	25	4	0.75	212	2656	373	EPD3004SW1400
3	M	28.5	6	1	16	380	59	EPD3006SW0300	14	M	32.5	6	1	212	1770	468	EPD3006SW1400
3	L	37.25	8	1.5	16	252	78	EPD3008SW0300	14	L	42.25	8	1.5	212	1328	607	EPD3008SW1400
4	S	22.75	4	0.75	30	850	74	EPD3004SW0400	16	S	25	4	0.75	276	2850	418	EPD3004SW1600
4	M	29.5	6	1	30	566	94	EPD3006SW0400	16	M	32.5	6	1	276	1900	525	EPD3006SW1600
4	L	38.5	8	1.5	30	424	124	EPD3008SW0400	16	L	42.25	8	1.5	276	1424	680	EPD3008SW1600
5	S	21.5	4	0.75	42	1002	97	EPD3004SW0500	18	S	25	4	0.75	338	3192	463	EPD3004SW1800
5	M	27.5	6	1	42	668	120	EPD3006SW0500	18	M	32.5	6	1	338	2128	581	EPD3006SW1800
5	L	33.75	8	1.5	42	501	143	EPD3008SW0500	18	L	42.25	8	1.5	338	1596	753	EPD3008SW1800
6	S	21.5	4	0.75	53	1140	106	EPD3004SW0600	20	S	25	4	0.75	404	3532	508	EPD3004SW2000
6	M	27.5	6	1	53	760	130	EPD3006SW0600	20	M	32.5	6	1	404	2354	637	EPD3006SW2000
6	L	33.75	8	1.5	53	570	155	EPD3008SW0600	20	L	42.25	8	1.5	404	1766	826	EPD3008SW2000
8	S	22.5	4	0.75	83	2424	168	EPD3004SW0800	24	S	25	4	0.75	481	3872	598	EPD3004SW2400
8	M	29	6	1	83	1616	209	EPD3006SW0800	24	M	32.5	6	1	481	2580	750	EPD3006SW2400
8	L	35.75	8	1.5	83	1212	250	EPD3008SW0800	24	L	42.25	8	1.5	481	1936	972	EPD3008SW2400

	Proposal/Inquiry/Order No.:	NOTES:
	Customer Name:	
Project Name:		
Contractor:		
Model EP expansion joints combine excellent performance and economy. They can usually be provided quickly.		
PRINT CERTIFICATION: Certified Correct As Of: _____ By: _____		